

Protector[®] Work Stations

for histology and pathology



Protecting your
laboratory environment

LABCONCO[®]

ALYS Labware, Lausanne

Tel : 021 312 42 60

Fax : 021 312 42 61

labware@alys-technologies.com



Protector Work Station is ideal for staining or grossing tissue.

Walk into your lab and breathe deeply. If you smell formaldehyde and organic solvent vapors, your lab may be improperly ventilated. If you're no longer detecting them — and your work area isn't adequately ventilated — it could mean you've become accustomed to the potential health hazard of toxic vapors from solvents and fixatives you work with daily.

Studies confirm that repeated exposure to formaldehyde, xylene, toluene and other organic solvents can cause a variety of symptoms including headaches, eye irritation, upper respiratory tract problems, disturbed sleep, dermatitis and impaired memory. Formaldehyde, breathed in certain concentrations over a period of time, has been identified as a suspected cancer-causing agent. Such findings prompted OSHA Final Rule 1910.1048 (May 27, 1992) that designated the time-weighted average (TWA) exposure to formaldehyde as 0.75 ppm within an 8 hour workday.

Responding to this ventilation problem and drawing on our fume hood technology expertise, **Labconco engineers designed a work station specifically for the needs of pathologists and histotechnologists.**

Like a traditional fume hood, the Protector® Work Station has a front air foil and rear baffle which direct the inflow of air so that it sweeps across the work area and away from the operator, keeping chemical vapors contained within the enclosure. Ideal for cramped or crowded labs, the work station has a low profile — only 24" high — so it fits easily under standard upper cabinets. Its accessory Work Surface is solid epoxy to withstand gross sectioning, trimming, cover-slipping and staining procedures. The optional deep sink and hose with spray nozzle help keep the work area clean.

Exhausting solvent vapors to the outside is the safest and most effective way to maintain good ventilation in the laboratory. Protector Work Stations are available in several styles to meet a variety of ducting limitations. The Protector Work Station designed for connection to a remote blower has the unique option of ducting from its back, top or either side. This design flexibility can save you hundreds of dollars in installation costs. Or, opt for the convenience of ordering the model with built-in blower. Protector Work Stations designed for outside exhausting rid the laboratory of a broad range of solvent vapors, from toluene and formaldehyde to xylene.

If there is no feasible way to vent your station to the outside, models with a built-in blower are available which use specially treated charcoal filters. These filter packs keep low level concentrations of toluene, xylene, formalin and formaldehyde below their OSHA-recommended time-weighted averages, restoring clean air for you to breathe. To ensure your technicians' safety and the appropriateness of using a filtered work station, please contact Labconco at 800-821-5525 or 816-333-8811 to discuss your laboratory's applications.

ALYS Labware, Lausanne
Tel : 021 312 42 60
Fax : 021 312 42 61
labware@alys-technologies.com



The Protector Work Station was designed with cooperation from members of the National Society for Histotechnology and leading pathologists.



Protector Work Station with Built-In Blower 69410-01 is shown on Solid Epoxy Work Surface 48828-01 and Protector Solvent Storage Cabinet 48830-00.

**69410-01
Protector Work Station with Built-In
Blower for ducting to the outside**

WORK STATION is 59 3/4" wide x 22 5/16" deep x 23 1/2" high (151.8 x 56.7 x 59.7 cm) for operation on 115 volts, 60 Hz, 15 amps AC. Working depth is 13 3/4" (34.9 cm). Side walls are hardboard covered with phenolic/melamine laminate, and the top and exterior back are epoxy-coated steel. One 30-watt fluorescent light, one switch, air foil, and an 8-foot, three-wire cord with plug are provided. A stainless steel grille with baffle is located in the rear of the Work Station. A hinged sash of tempered 1/4" thick safety glass provides a work opening of 10" and swings up to an access opening height of 19". Colors are glacier white and charcoal.

BUILT-IN BLOWER draws 3 amps and is capable of overcoming external static pressure loss of .33" H₂O at 50 fpm (167 CFM). A 6" x 6" square to 6" diameter round adaptor is provided above the blower for connection to the exhaust system. *Shipping weight 114 lbs. (51.7 kg)*



Protector Work Station without Blower 69410-03 is shown on Protector Work Surface 69420-01 and Base Stand 80870-00.

**69410-03
Protector Work Station without
Blower for use with remote blower**

WORK STATION is 47 3/4" wide x 22 5/16" deep x 23 1/2" high (121.3 x 56.7 x 59.7 cm) for operation on 115 volts, 60 Hz, 15 amps AC. Working depth is 13 3/4" (34.9 cm). Side walls are hardboard covered with phenolic/melamine laminate, and the top and exterior back are epoxy-coated steel. One 30-watt fluorescent light, one switch, air foil, and an 8-foot, three-wire cord with plug are provided. A stainless steel grille with adjustable baffle is located in the rear of the Work Station. A hinged sash of tempered 1/4" thick safety glass provides a work opening of 10" and swings up to an access opening height of 19". Colors are glacier white and charcoal.

Work Station can be ducted using one of the three 3 1/4" x 10" openings located on the top and both sides of the station, or by using the 6" nominal diameter opening in the back. Static pressure loss through the work station does not exceed .28" H₂O at 50 fpm (167 CFM). **Work Station requires remotely located blower (not included) for operation.*** *Shipping weight 93 lbs. (42.2 kg)*

69410-02
Protector Work Station with
Built-In Blower for use with
charcoal filters

WORK STATION is 59 3/4" wide x 22 5/16" deep x 23 1/2" (151.8 x 56.7 x 59.7 cm) high for operation on 115 volts, 60 Hz, 15 amps AC. Working depth is 13 3/4" (34.9 cm). Side walls are hardboard covered with phenolic/ melamine laminate, and the top and exterior back are epoxy-coated steel. One 30-watt fluorescent light, one switch, air foil, and an 8-foot, three-wire cord with plug are provided. A stainless steel grille with baffle is located in the rear of the Work Station and provides access to the charcoal filters (not included).* A hinged sash of tempered 1/4" thick safety glass provides a work opening of 10" and swings up to an access opening height of 19". Colors are glacier white and charcoal.

BUILT-IN BLOWER draws 3 amps, provides 50 fpm face velocity and requires no ducting. *Shipping weight 114 lbs. (51.7 kg)*

Models
69410-01, 69410-02 and 69410-05

TOP VIEW

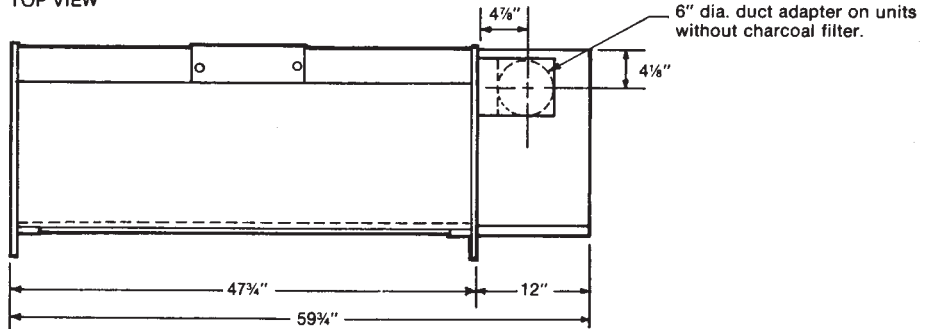

FRONT VIEW

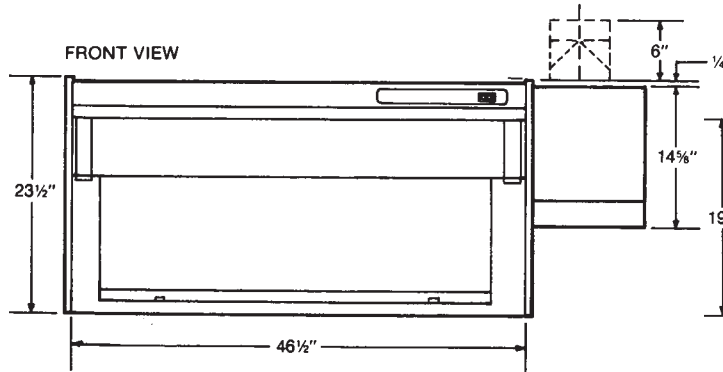

SIDE VIEW

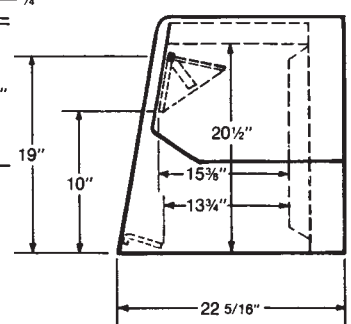

Model
69410-03

TOP VIEW

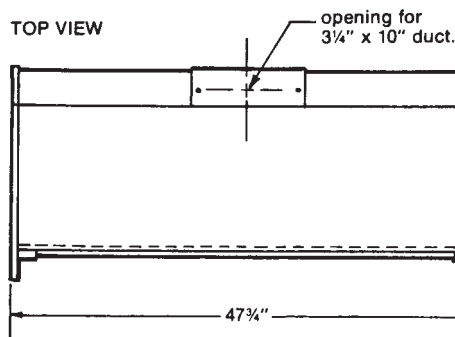

FRONT VIEW

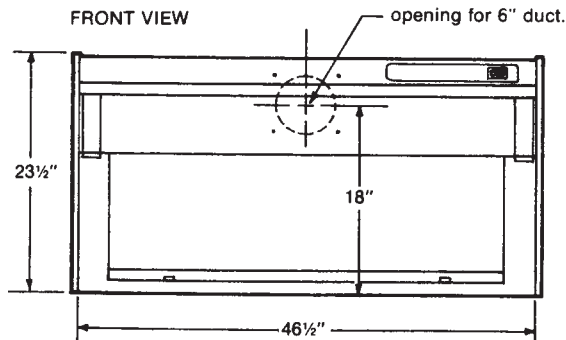

SIDE VIEW

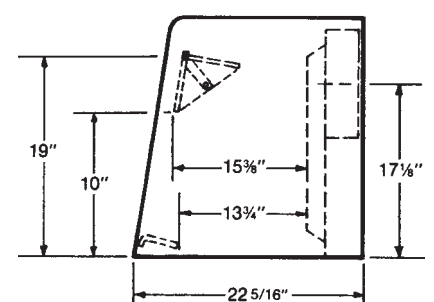

69410-05
Protector Work Station with
Built-In Blower for use with
charcoal filters

Specifications are the same as for 69410-02 above except for the following changes. Work Station operates on 220 volts, 50 Hz, 7 amps AC, blower draws 2 amps and includes an 8-foot, three-wire cord. **An electrical plug is required.**

Charcoal Filter Packs For Models 69410-02 and 69410-05

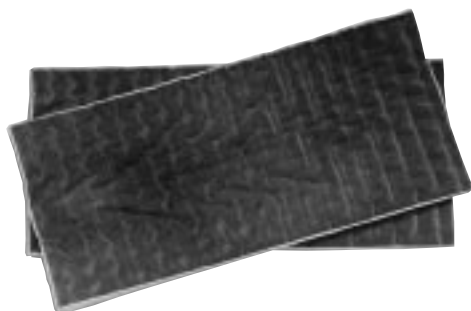

If there is no economical or feasible way to provide outside ventilation to your laboratory, then choose Protector Work Station 69410-02 or 69410-05. Because these work stations use replaceable charcoal filter packs that adsorb dangerous chemical fumes, no ducting is required. These models

require regular monitoring with gas detector tubes (not included). Filter packs are available in two formulations:

- (1) for applications involving xylene and toluene only.
- (2) for applications involving formalin and formaldehyde as well as xylene and toluene.

Catalog #	Description	Shipping Weight
69418-00	Xylene/Toluene Filter Pack includes two activated carbon filters for adsorbing xylene and toluene. Each filter contains 15 pounds of media.	32 lbs. (14.5 kg)
69419-00	Formalin/Formaldehyde Filter Pack includes one activated carbon filter for adsorbing xylene and toluene and one specially treated filter for adsorbing formalin and formaldehyde. Each filter contains 15 pounds of media.	32 lbs. (14.5 kg)

(If you are NOT using formalin and formaldehyde, order 69418-00 only.)

Remote Blower For Model 69410-03 (for exterior mounting)



Remote Blower 70535-00 is sized to meet the air volume requirements of the Protector Work Station 69410-03. It has a 1/4 hp direct drive motor capable of overcoming external static pressure loss of .87" H₂O at 167 CFM (50 fpm face velocity). Housing and wheel are corrosion-resistant enamel-coated steel. Discharge direction is adjustable to accommodate unusual blower locations. Blower inlet is 6" ID. Outlet dimension is 4 1/4" x 7 3/8" OD.

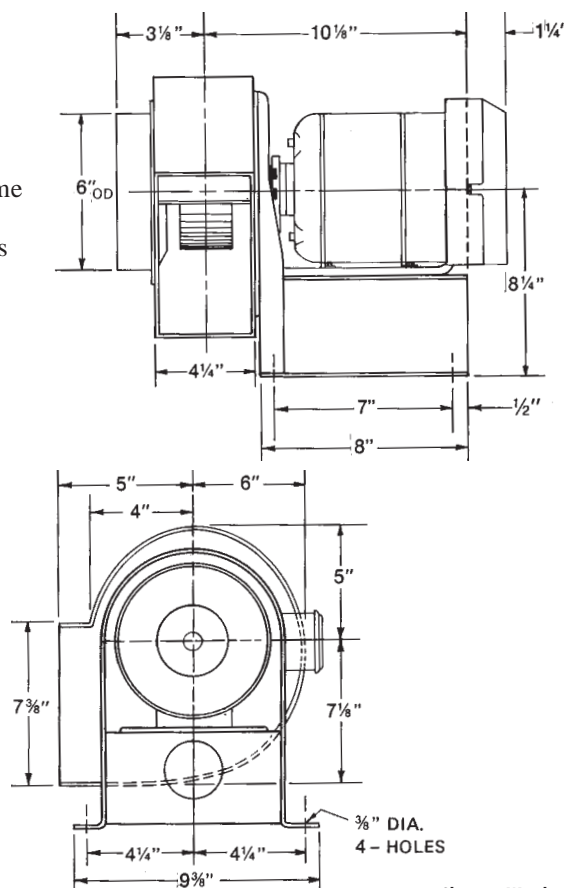

Catalog #	Description	Shipping Weight
70535-00	Remote Blower for Protector Work Station without blower	35 lbs. (15.9 kg)

Thermoplastic Duct



Female Duct Coupling

Thermoplastic Duct For Models 69410-01 and 69410-03

PVC Exhaust Duct is lightweight and corrosion-resistant. This rigid duct may be cut without special tools.

Duct comes in 10' lengths. A PVC Female Duct Coupling is required to join two sections.

Catalog #	Description	Shipping Weight
47086-00	Thermoplastic Duct , 6" nominal diameter, 10' length	25 lbs. (11.3 kg)
47089-00	PVC Female Duct Coupling , 6" nominal diameter	4 lbs. (1.8 kg)

Transition Adapters For Model 69410-03

Protector Work Station 69410-03 allows you to exhaust from the top, sides or back. The following epoxy-coated

steel transition adapters provide easy connection to standard 6" diameter duct.

Ducting Options	Exhaust	Catalog #	Description	Shipping Weight
1	From back without damper	69401-00	6" dia. round adaptor	2 lbs. (0.9 kg)
2	From back with damper	69402-00	6" dia. round adaptor with damper	2 lbs. (0.9 kg)
3	From top	69403-00	3 1/4" x 10" rect. to 6" dia. straight	2 lbs. (0.9 kg)
4	From left side	69403-00	3 1/4" x 10" rect. to 6" dia. straight	2 lbs. (0.9 kg)
5	From right side	69403-00	3 1/4" x 10" rect. to 6" dia. straight	2 lbs. (0.9 kg)
6	From back, right end	69404-00	3 1/4" x 10" rect. to 6" dia., 90° elbow	2 lbs. (0.9 kg)
7	From back, left end	69404-00	3 1/4" x 10" rect. to 6" dia., 90° elbow	2 lbs. (0.9 kg)



69401-00

69402-00



69403-00

69404-00

DUCTING OPTIONS

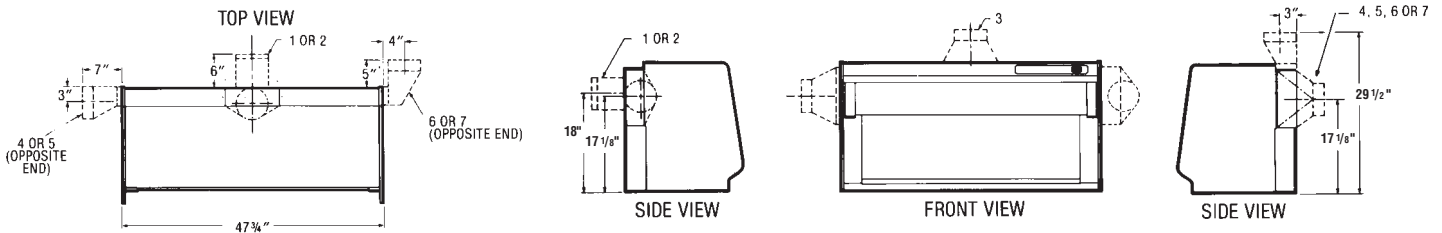

Work Surface with Sink

Fabricated from durable epoxy resins, this unique work surface is designed to accept standard dissecting boards and is dished to contain spills. It resists corrosion and will not stain or absorb liquids. Easy to clean, the work surface comes with a 10" x 14" x 6" deep (25.4 x 35.6 x 15.2 cm) molded epoxy sink. Fixtures include a chrome-plated gooseneck faucet with vacuum breaker, two chrome-plated faucet controls, and a spray nozzle with hose. Sink requires a 1 1/2" drain connection. This work surface may be mounted on Base Stand 80870-00 or 80870-01. See back page for Base Stand ordering information.



Work Surface 69420-00

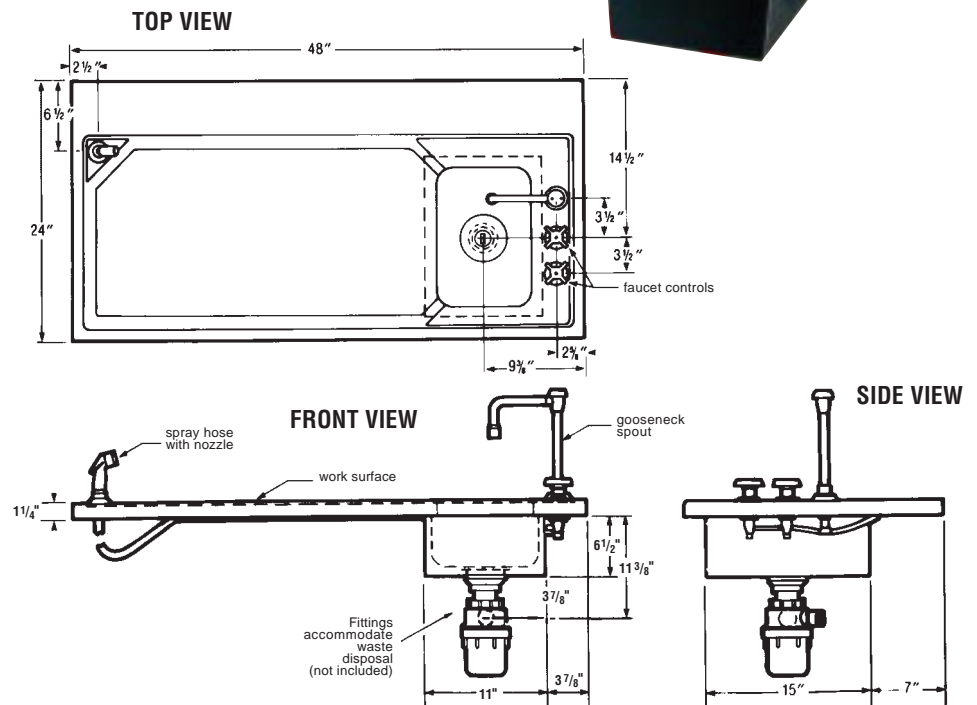

Catalog #	Description	Shipping Weight
69420-00	Work Surface with sink and fixtures, 48" w x 24" d x 1 1/4" thick (121.9 x 61 x 3.2 cm)	115 lbs. (52.2 kg)



Base Stand 80870-00

Base Stands

The Base Stand is the recommended support for the Protector Work Station and Work Surface with Sink. The Base Stand allows easy access to plumbing

and drain lines and comes complete with leveling feet and foot rest. It is available in two heights for sitting or standing. Color is charcoal.

Catalog #	Description	Shipping Weight
80870-00	Base Stand for use while sitting, 50 3/8" w x 30 3/4" d x 28 3/4" h (128 x 78.1 x 73 cm)	194 lbs. (88 kg)
80870-01	Base Stand for use while standing, 50 3/8" w x 30 3/4" d x 34 3/4" h (128 x 78.1 x 88.3 cm)	194 lbs. (88 kg)

A flat work surface is also available. See below.



Protector Solvent Storage Cabinet 48830-00

Protector Solvent Storage Cabinet and Flat Work Surface

The Protector Solvent Storage Cabinet provides convenient storage of chemicals under the Protector Work Station. Constructed of heavy 18-gauge dual wall steel with 1 1/2" air gap, it is equipped with locking doors, an adjustable dished steel shelf, leveling

legs and rear vent outlets for safe and easy installation. **The cabinet requires a flat work surface, such as Solid Epoxy Flat Work Surface 48828-01, to support the Protector Work Station. Not for use with Work Surface 69420-00.**

Catalog #	Description	Shipping Weight
48830-00	Solvent Storage Cabinet , 47" w x 22" d x 35 3/4" h (119.4 x 55.9 x 90.8 cm)	350 lbs. (158.8 kg)
48828-01	Solid Epoxy Flat Work Surface , 47 3/4" w x 30" d x 1 1/4" thick (121.3 x 76.2 x 3.2 cm) See photo on page 2.	100 lbs. (45.4 kg)

Contact Labconco at 800-821-5525 or 816-333-8811 for information on these other laboratory ventilation products.



Fume Hoods
& Blowers



Charcoal-Filtered
Enclosures



Fume Adsorbers

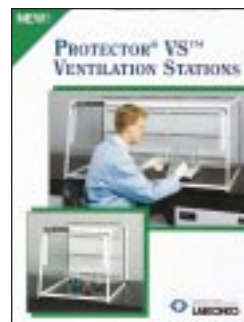

Ventilation
Stations



Safety Cabinets,
Enclosures &
Clean Benches

ALYS Labware, Lausanne
Tel : 021 312 42 60
Fax : 021 312 42 61
labware@alys-technologies.com



Protecting your
laboratory environment

LABCONCO



Labconco Corporation • 8811 Prospect Avenue, Kansas City, MO 64132-2696

(816) 333-8811 • (800) 821-5525 • FAX: (816) 363-0130 • E-mail: labconco@labconco.com • Home Page: www.labconco.com